

FLUXDOCK

FACTSHEET WORKPLACES

Fluxdock was founded in Basel in 2015 with the aim of developing a platform for cross-company collaboration. In 2016, we opened our office in Dreispitz. Today, representatives and experts from a wide variety of industries meet there every day to develop their projects through collaboration.

We welcome your inquiry, with no obligation

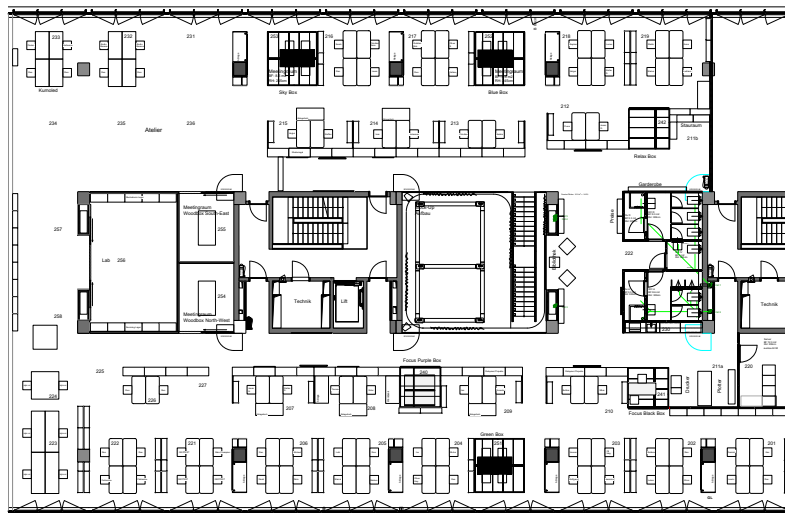

Disclaimer: We reserve the right to adjust the listed prices at any time. Please refer to the quote provided after you contact us for the binding terms and conditions regarding room rental and services. Thank you for your understanding.



As a tenant, you can take advantage of our versatile infrastructure free of charge and book it at any time.



STAGE

The Stage is a modular space designed for presentations, prototypes, exhibitions, and events. From mock-ups and exhibition setups to lectures, performances, photo and film shoots, and more—the Stage provides the perfect setting to bring ideas to life and explore new possibilities.

WHITEBOXES

Our modular rooms are versatile and can be used as needed for both small-scale workshops and large-scale conferences and presentations.



MEETING BOXES

The meeting boxes on the upper floor offer flexible spaces for focused work, team meetings, or confidential discussions. There are two telephone boxes and rooms for up to six people—ideal for small teams, brainstorming sessions, or project meetings. All boxes are optimally equipped for online meetings and video conferences.

TOWNHALL

The Townhall is the social heart of Fluxdock and also the first space you encounter upon entering—serving as both a central gathering place for tenants and a lobby. Whether it's a lunch break, a spontaneous meeting, a cocktail hour, or networking, the Townhall offers an open, flexible space for socializing, conversations, and events.





WORKSHOPS

As a collaborative space, Fluxdock also houses workshops for craft, technical, and creative projects. Facilities include a well-equipped wood and metal workshop with a CNC router, a 3D printing workshop, an electronics station, a technical supply room, and a plotter—ideal for prototypes, models, or technical experiments.

RELAXBOX

Another special feature of Fluxdock is a small retreat: the Relaxbox - ideal for short breaks or a power nap. Regular short breaks promote creativity and concentration - here, our tenants can consciously switch off, recharge their batteries, and clear their heads.



LOCATION

Fluxdock is a collaborative studio used by several award-winning companies in the fields of engineering, event management, architecture, design, software development, live communication, and immersive visitor experiences. We are a professional workspace and venue located in the vibrant creative and engineering heart of Basel, the Dreispitz.

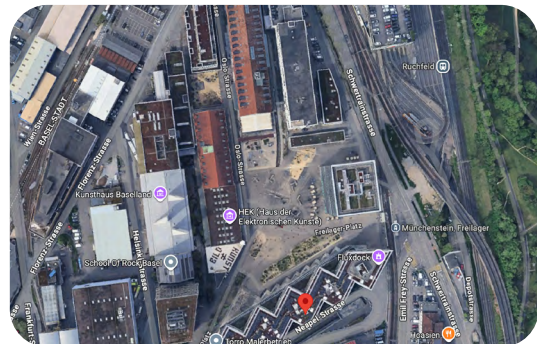
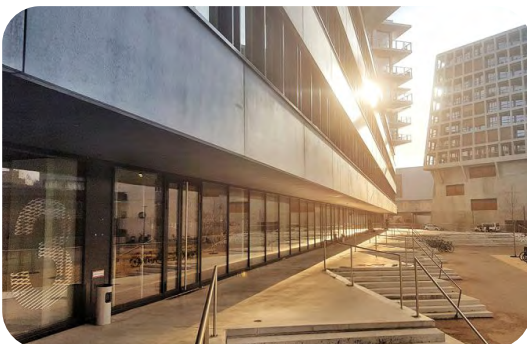
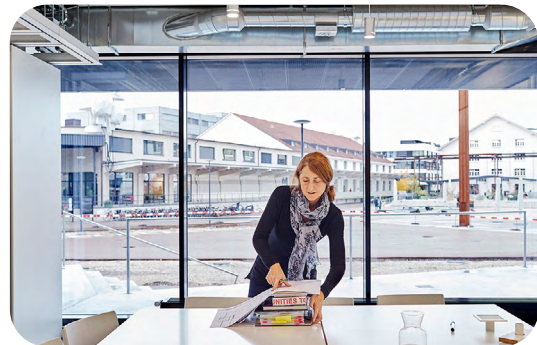



FACTSHEET WORKPLACES

At Fluxdock, you can rent permanent workstations—ideal for anyone who wants to work regularly in a professional and collaborative environment. Our workstations provide everything you need to work productively—24/7, 365 days a year.

WE HAVE SPACE - For your business or project: Up to 475 m² - available immediately - all-inclusive:

OUR ALL-INCLUSIVE PACKAGE AT A GLANCE



PERSONAL USE

24/7/365 access

Permanent Workplace

Shelf and storage space

High-Speed Internet (10 Gigabit)

**Great coffee and tea,
all you can drink**

**Space for mock-ups, prototypes,
and professional client
presentations**

private mailbox

**Optional: Space for your server in
the server room, including
professional in-house IT support**



SHARED USE

**Free use of meeting and event
rooms equipped with professional
equipment and furniture:
Whiteboxes, Stage, meeting and
focus boxes, Daily Zones, and
breakout areas**

**Zugang zu Werkstätten für Holz,
Metall, 3D-Druck und Elektronik**

**Access to woodworking,
metalworking, 3D printing, and
electronics workshops**

**Lounge & Library, RelaxBoX, and
common areas such as the Town
Hall**

**Kitchen equipped with a
professional microwave and
commercial dishwasher; kitchenette
on the upper floor**

**On-site kiosk offering drinks,
snacks, and ice cream**

**bathroom facilities, including
showers**

Shared use of our e-cargo bike



STUDIO MANAGEMENT SERVICES INCLUDED

Administration, Management, and Insurance

Cleaning, Maintenance, and Landscaping Services

Infrastructure Repair and Maintenance

Internal Communication (coordination with property management and other tenants, internal newsletter, management of welcome and display screens)

Key management and digital services (room reservation tool and media control)

Implementation and maintenance of new features in Fluxdock upon request from our tenants

Procurement & provision of office supplies and consumables

Event management: Support with the planning and execution of your in-house events as needed

...and much more

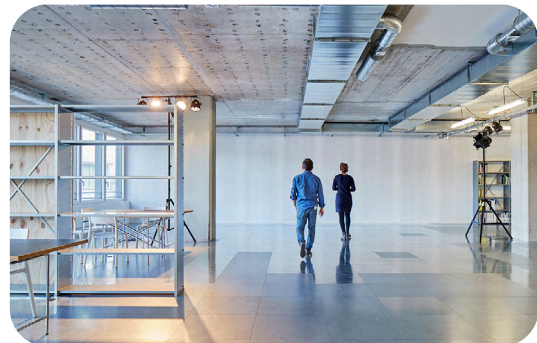
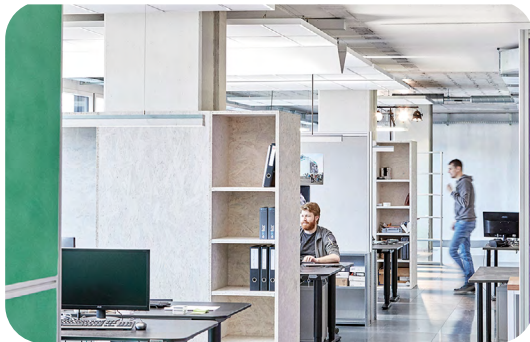



ADDITIONAL BENEFITS

No hidden costs: Electricity, water, waste disposal & recycling, heating, fresh air supply, and air conditioning are included in the price.

We offer elegant meeting spaces for client meetings and presentations at no charge. In addition, we are located in a building designed by star architect Bjarke Ingels (BIG) and completed in 2016—the Transitlager.

Central location: Fluxdock is just 5 tram stops away from the Basel SBB train station – the “Freilager” tram stop is right outside our front door. A parking space can also be rented upon request.

An innovative and professional environment: a community of award-winning companies in the fields of architecture, engineering, design, (live) communication and event management, software development, geology, 3D rendering, and immersive visitor experiences awaits you.

Collaborative mindset: informal exchanges, active knowledge transfer, workshops, internal initiatives, and joint activities foster networking, collaboration, and professional development.

A wide variety of dining options are available nearby: various food trucks, the Academy of Art and Design and Spengler cafeterias, a museum bistro, and restaurants serving Italian, Asian, and home-style cuisine are all just a few minutes' walk away.

An inspiring neighborhood of institutions and companies such as the FHNW Academy of Art and Design (HGK Basel), the HEK (House of Electronic Arts), Radio X, RAPP, the Kunsthaus Baselland, the Herzog & de Meuron, and the School of Design with its library and internationally renowned poster collection, among many others. Local recreational areas such as the Meriangärten, the Park im Grünen, and—starting in 2027—Switzerland's longest natural swimming pool, the so-called “Gleispool,” are just around the corner. Cultural highlights such as Museum Night, the MESH Festival, or events held as part of Art Basel on and around the Freilagerplatz round out the offerings.

COST PER WORKPLACE: ALL-INCLUSIVE

840 CHF/MONTH (EXCL. VAT)

Get started with your creative work at Fluxdock—everything included, available right away. Enjoy a dedicated workspace in a professional, collaborative environment with access to all studios, workshops, meeting rooms, and services.

[Contact us—we'd be happy to assist you: info@fluxdock.io](mailto:info@fluxdock.io)

It is also possible to rent space on a per-square-meter basis:

Net rent: CHF 240.00CHF/m²/year | Utilities: CHF 30.00 CHFF/m²/year | Services not included

Infrastructure: pay-per-use